



# THE BOTANIC GARDEN OF SMITH COLLEGE

The Botanic Garden of Smith College was founded over one hundred years ago by L. Clarke Seelye, the College's first president, who expressed his hope that the whole campus could be developed as a botanic garden so that it might be of scientific as well as aesthetic value. The landscape architecture firm of Frederick Law Olmsted, of Central Park fame, was enlisted to create that plan.

The spirit of this concept has persisted at Smith College since that time and remains basic to our purpose. Today the Botanic Garden serves as a living museum of plants native to New England and areas all around the globe. Our goals are education, research, display, and conservation. The Garden encompasses the Lyman Conservatory and the 125 contiguous acre college campus with a variety of specialty gardens, which contain over 7000 labeled and mapped plants.

## LYMAN PLANT HOUSE:

- ◆ **Open daily 8:30 am – 4:00 pm.** Closed Thanksgiving Day and Winter Break: Christmas thru New Year's.
- ◆ **Lyman Conservatory:** One of the few remaining conservatories in the United States built in the 19<sup>th</sup> century, core greenhouses dating from 1895, built by Lord & Burnham, and renovated in 2003. (See reverse for floor plan.)  
**Spring Bulb Show:** Starts the first Saturday in March and runs for two weeks including the third weekend. Hours for the general public are 10:00 am – 4:00 pm daily.  
**Fall Chrysanthemum Show:** Starts the first Saturday in November and runs for two weeks including the third weekend. Hours for the general public are 10:00 am – 4:00 pm daily.  
**Woods of the World Display:** Permanent installation of 178 different kinds of wood, decoratively displayed in a celebration of biodiversity, with detailed information about the woods and different types of grain patterns.
- ◆ **Plant Life Through the Ages:** Permanent installation of an 8 panel mural depicting great moments in plant evolution.
- ◆ **Church Exhibition Gallery:** Changing educational displays — check online for current display.  
<https://www.smith.edu/garden/exhibits>
- ◆ **Conservatory Collection:** 12,000 square feet containing approximately 1500 taxa. Collections include succulents, ferns, tropicals, subtropicals, and epiphytes, arranged biogeographically.

## CAMPUS GARDENS AND ARBORETUM:

- ◆ **Campus Arboretum:** Features over 1100 woody trees and shrubs spread throughout the campus.
- ◆ **Systematics Garden:** most recent reorganization in 2014, reflecting the understanding of plant classification at the time. It is laid out in a visual representation of a phylogenetic tree, which represents the lineages of organisms as they evolve through time.
- ◆ **Rock Garden:** Established in 1897 by William Ganong and Edward Canning it contains over 1800 alpine taxa. One of the oldest Rock Gardens in North America, it was restored by William Campbell in 1937 and again in 1983 by Gregory Armstrong and Ellen Shukis. Modeled on the Rock Garden at Kew it exhibits outcrop, moraine, and scree rock formations of alpine habitats.
- ◆ **Ruth Brown Richardson '13 Memorial Perennial Border:** Planted in 1984 for purely ornamental purposes, along the fence bordering College Lane.
- ◆ **Happy Chace '28 Garden:** adjacent to the President's house offers views of Paradise Pond and the Holyoke mountain range. Redesigned and renovated in 2016 it now also includes a pavilion and handicapped accessibility.
- ◆ **Wildflower and Woodland Garden:** Situated along the ravine behind the President's House.
- ◆ **Japanese Garden for Reflection and Contemplation:** the garden was re-envisioned in 2017 by Japanese garden consultant John Powell and features repurposed materials. A stepping stone path provides distinctive scenes at each turn and leads to a stone bench with views over the pond towards Mt. Tom. Rock compositions depict various stages in the life of Buddha.
- ◆ **Capen Garden:** A quiet garden space, it is used as an outdoor laboratory for horticulture students. It is designed as a series of outdoor garden rooms each with its own character, including a formal knot and gazebo garden, and a fountain donated by the Friends of the Botanic Garden.

# The Lyman Plant House and Conservatory The Botanic Garden of Smith College

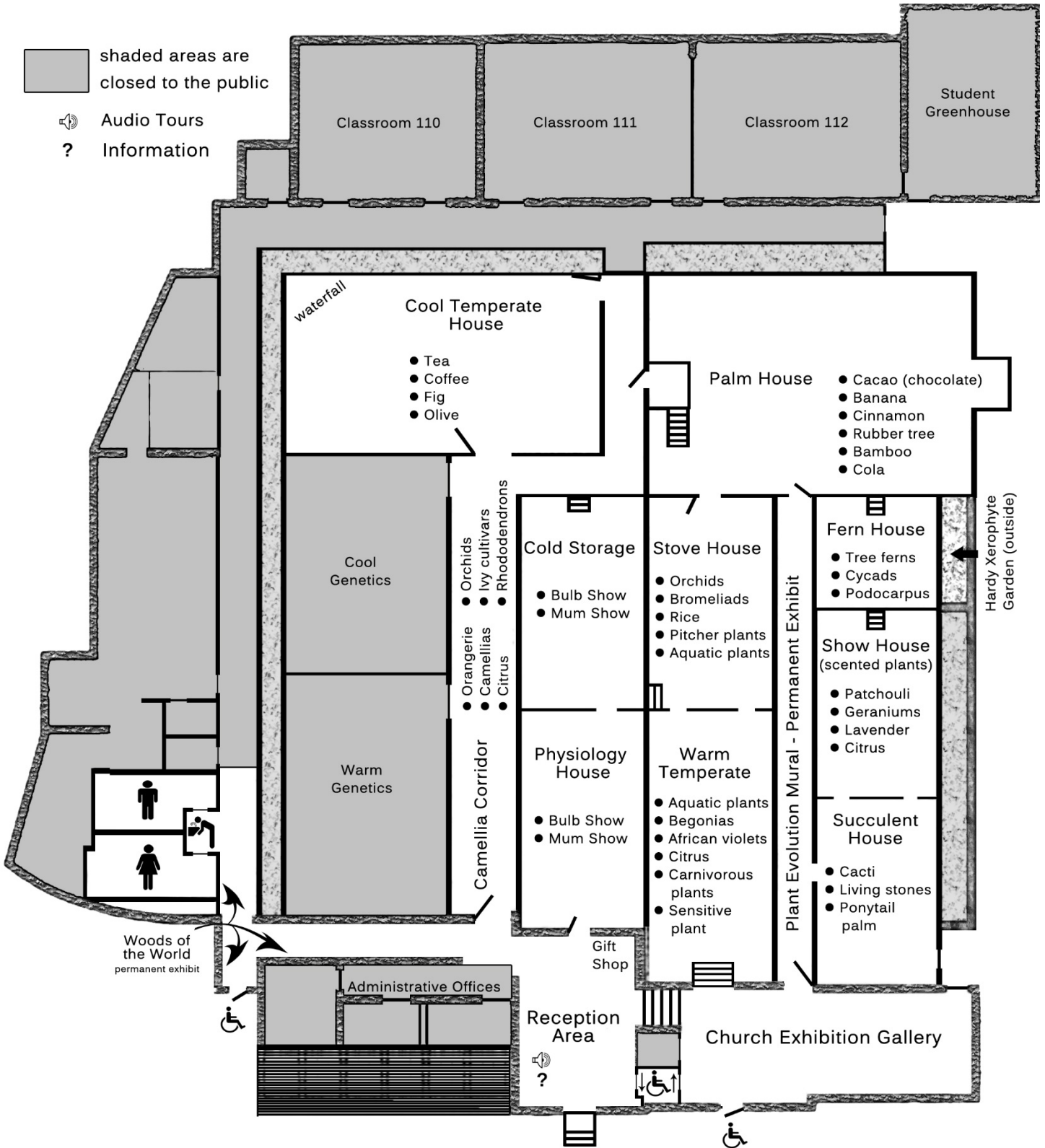

Main Entrance on College Lane

Building closes promptly at 4:00 pm. Please plan your visit accordingly.